

MODULAR COMPACT SOLUTIONS FOR MUNICIPAL WATER TREATMENT

Customer's Challenges

Municipal authorities are meeting challenges to find the suitable solutions to solve common environmental problems such as:

- scarce water resources and extreme weather response management,
- health and sanitation concerns,
- stringent environmental regulations.

Veolia has answered the diverse municipal water treatment needs with the **Modular market-leading technologies (concrete structure)**

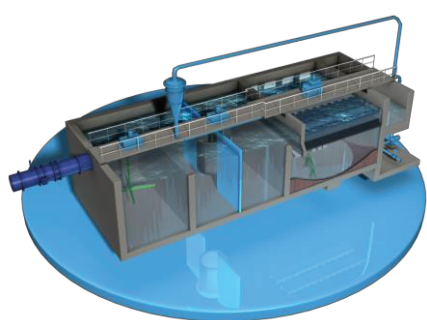

ACTIFLO®

Actiflo® is a **compact process for high rate clarification**. The specificity of Actiflo® resides in the use of **microsand**, which acts as a ballast for flocculated matter and accelerates its settling.

*** For the production of **drinking water and process water**, Actiflo® treats surface water, ground water, sea water and brackish water. It is particularly effective in eliminating turbidity, natural organic matter, color and algae.

*** Actiflo® can also be implemented at all stages of the treatment of **municipal effluents** such as primary and secondary clarification, tertiary polishing, and reuse of wastewater. This is an ideal technology thanks to real-time treatment of stormwater flows and Phosphorus removal as it is compliant with the strictest standards, with reductions exceeding 95%.

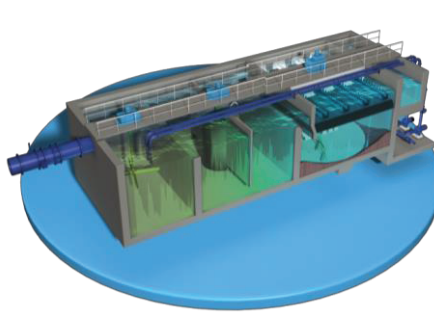

MULTIFLO™

In the municipal market, **MUTIFLO™** is the reference for surface water and seawater pre-treatment, but also for primary, secondary and tertiary wastewater.

The MULTIFLO process combines the **coagulation, flocculation and counter-current lamella settling stages in a single unit**. Inclined lamella plates located side-by-side create modular sedimentation units. Compared with conventional settlers this configuration provides a **larger settling surface area within a similar footprint**. Moreover, the lamella plates enhance settling of the less solubles flocs by improving the hydraulic distribution of the water and reducing turbulence.

Applications



POTABLE WATER



WASTE WATER



DESALINATION

TURBOMIX™

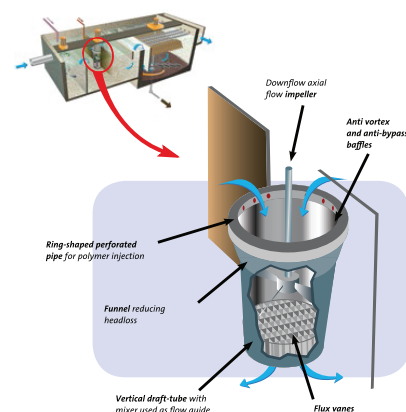

This is a **patented flocculation mixing** providing:

- ✓ Removal of by-pass and dead zones to achieve classical flocculation efficiencies in a smaller tank
- ✓ Complete mixing of the influent water with the chemicals and the re-circulated sludge
- ✓ Increased pumping efficiency for a same power consumption
- ✓ Reduced polymer consumption



MODULAR WATER TREATMENT PLANT

Compact Technologies

- Concrete compact solutions for space constrained area
- Modular wastewater treatment plant offers high capacity treatment in small footprint for municipal effluent

Competitive Offer

- In-depth pre-engineered solution
- Pre-selected quality proven equipment
- Designed using 3D model for easy construction
- Reliable and responsive on-site services

Time & Cost Effectiveness

- Execution deliverables readily available for
 - ✓ Design
 - ✓ Equipment
- Earlier start of Construction Works

Modular Processes Bundling

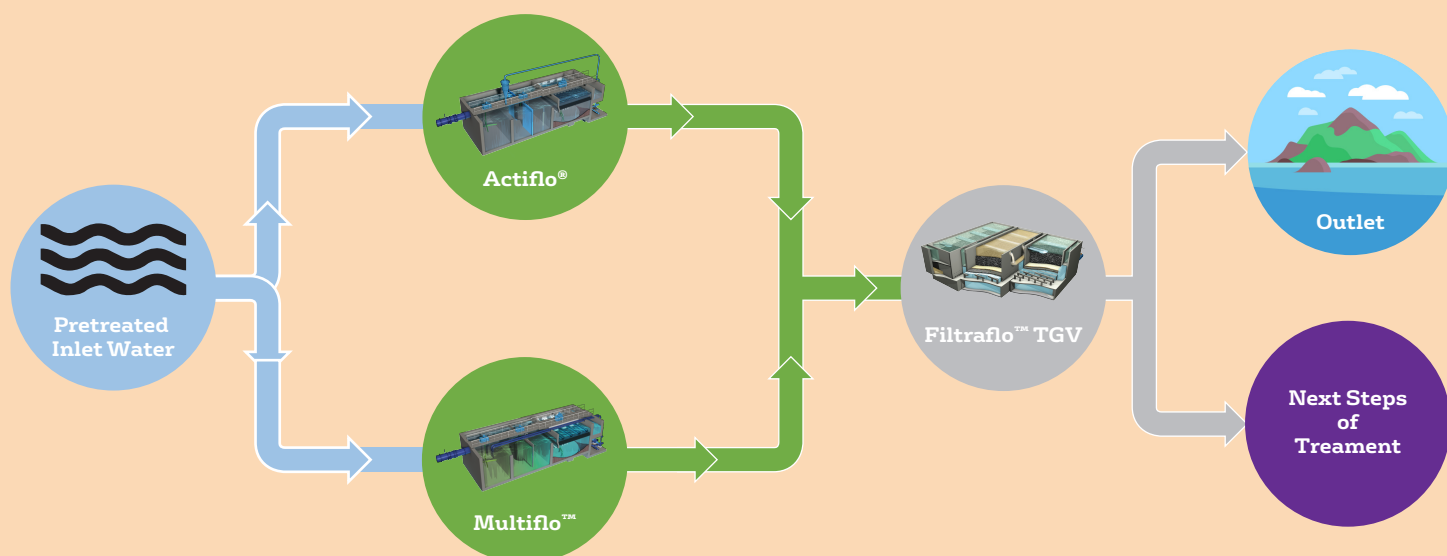

Veolia's Services

Maintenance Services Contract



AQUAVISTA™

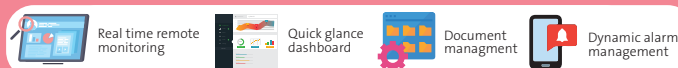

HYDREX™ Chemicals



Spare Parts & Consumables



www.veoliawatertech.com/asia/
 Linked Veolia Water Technologies Asia
marcom.apac@veolia.com